

The QPT20IC is part of the product line of “Smart” positioning systems significantly more capable than basic pan and tilt units. These enhanced designs embed powerful microprocessor controllers, which can be effortlessly programmed to adjust limits of motion, speed, and Az/EI position.

Embedded functions include preset repeatable positions, tours, jog or direct manual entry with 12 bit absolute position feedback, convenient edit and adjustable dwell times. The “Smart” concept eliminates the need for separate interface electronics and is connected to the control station using a cost efficient “single cable feed”. No calibration or homing cycle is required for startup. RS232/422/485 or optional Ethernet connectivity can be used to control not only the pan and tilt functions, but also the instruments and equipment mounted on the positioner. QuickSet “Smart” systems interface with stabilization and tracking systems, on- screen displays, and system interface programs of various types.

Key Features:

- Available in 12 or 24 VDC models
- Power supply optional
- Weather resistant
- Repeatability to 0.25°
- Comprehensive protocol command set allows complete operation control and configuration via any controller compatible with EIA RS232 or RS422 communication. Includes auto-baud detection and 6 ft. test cable.

*SPECIFICATIONS SUBJECT TO CHANGE WITHOUT NOTICE

Voltage:	12VDC	24VDC
Load Capacity:	Up to 20 lbs.	Up to 20 lbs.
	Center of gravity located at table top	Center of gravity located at table top
Pan Range:	435°(±217.5°)	435° (±217.5°)
	Continuous rotation optional	Continuous rotation optional
Pan Speed:		
Tilt Range:	180°(±90°)	180°(±90°)
Tilt Speed:		
Motor Type:	Permanent Magnet	Permanent Magnet
Connector:	MIL Spec 17 pin (mating connector supplied)	
Weight:	13.1 lbs. (5.94kg)	
Drive Train:	Steel worm drive system with self-aligning bearings	
Microprocessor Control:	Internal	
Limit Switches:	Internally adjustable "Hard Limits", electronically adjustable "Soft Limits"	
Backlash:	Adjustable	
Repeatability:	0.25°	
Materials:	Housing - Aluminum 6061-T6, Hardware Stainless Steel	
Exterior Color:	White Dupont 326162A, Ford PFWS9 Powdercoat	
	Custom colors and private labeling upon request	
Enclosure:	Environmentally gasketed and sealed, suitable for inverted operation	
Operating Temperature Range:	-28°F to +131°F (-33°C to +55°C)	
Heater:	Standard	
Position Feedback:	Precision Potentiometers	
Communication:	Comprehensive Protocol Command set allows complete operation control and configuration via any controller compatible with EIA RS232 or RS422 communication	
	Includes auto-baud detection & 6 foot test cable.	
Set-up commands include:	Electronic limit of motion for both pan and tilt	
	Setting of minimum and maximum speeds	
	Establishing 32 preset locations, including "home position"	
	"Tour" feature allows construction of up to 63 steps of the preset positions	
	continuously with variable dwell times between them. Three tours may be stored in	
	on board memory.	
	Setting normal/reverse mode of movement and position feedback	
	Alignment to local or global coordinates	
	Includes test/operational software (Requires Windows 95 SRw, 98, ME or XP; not	
	compatible with Windows NT or 2000)	
Test software features include:	Access to all setup parameters	
	Virtual joystick for jog position	
	Visual analog and digital position indicators, plus destination readouts	
	"Move To" feature via absolute direct entry, delta direct entry, and "move to home"	
	Set up and access of tour feature	
	Diagnostic communication and fault indicators	
	Protocol analyzer	
	Move monitor allows logging of positions acquired	

*SPECIFICATIONS SUBJECT TO CHANGE WITHOUT NOTICE

Dimension are in inches [mm]

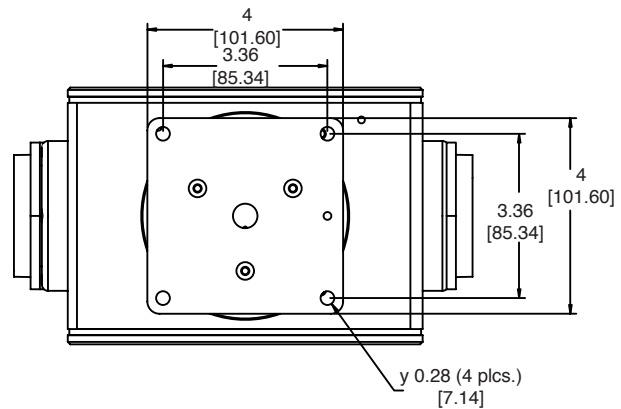
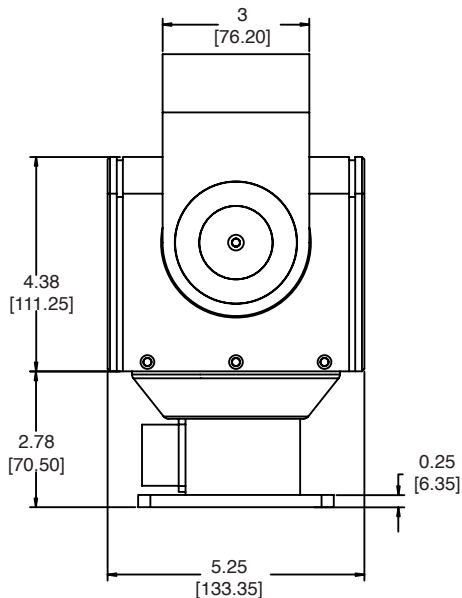
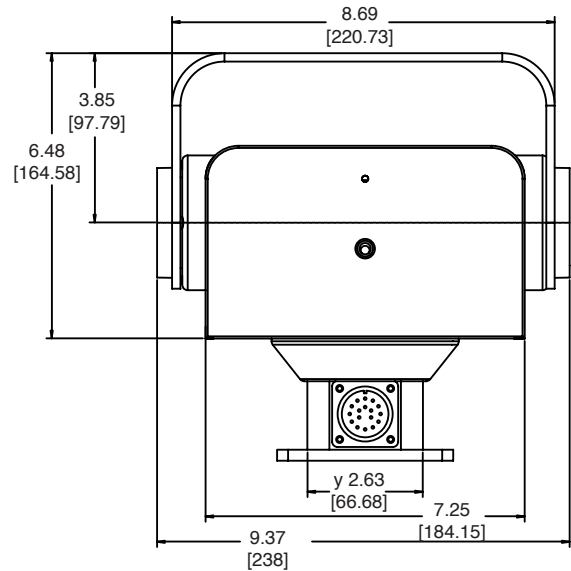
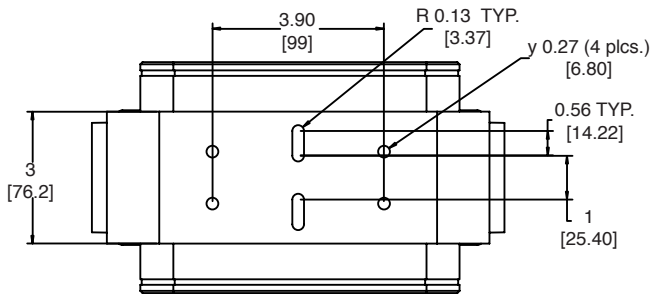

*SPECIFICATIONS SUBJECT TO CHANGE WITHOUT NOTICE

12/05 00012