

## Models Covered:

**QPT-20XD ... 12 & 24 VDC variable speed\***

**QPT-15XD ... 24 VAC fixed speed**

\* with proper controller

***Extra Durable***

**Electro-Mechanical Pan & Tilt**



MODEL	SERIES	DESCRIPTION
7-07000	QPT-20XD	24 VDC; pan 435°, 35°/sec; tilt ±90°, 12°/sec with pots, White
7-07000-BLK	QPT-20XD	24 VDC; pan 435°, 35°/sec; tilt ±90°, 12°/sec with pots, Black
7-07000-OD	QPT-20XD	24 VDC; pan 435°, 35°/sec; tilt ±90°, 12°/sec with pots, heater, Olive Drab
7-07005-OD	QPT-20XD	24 VDC; pan 435°, 35°/sec; tilt ±90°, 12°/sec with pots, Olive Drab
7-07010	QPT-20XD	24 VDC; pan 435°, 35°/sec; tilt ±90°, 12°/sec, White
7-07015-EC	QPT-20XD	24 VDC; pan 435°, 35°/sec; tilt ±90°, 12°/sec with encoders, White
7-07020	QPT-20XD	24 VDC; pan 435°, 8°/sec; tilt ±90°, 6°/sec, White
7-07025	QPT-20XD	24 VDC; pan 435°, 8°/sec; tilt ±90°, 6°/sec with pots, White
7-07030-EC	QPT-20XD	24 VDC; pan 435°, 8°/sec; tilt ±90°, 6°/sec with encoders, White
7-07035	QPT-20XD	12 VDC; pan 435°, 8°/sec; tilt ±90°, 3°/sec, White
7-07035-BLK	QPT-20XD	12 VDC; pan 435°, 8°/sec; tilt ±90°, 3°/sec, Black
7-07040	QPT-20XD	12 VDC; pan 435°, 8°/sec; tilt ±90°, 3°/sec with pots, White
7-07045	QPT-15XD	24 VAC; pan 435°, 8°/sec; tilt ±90°, 3°/sec, White
7-07050	QPT-20XD	12 VDC; pan 435°, 23°/sec; tilt ±90°, 12°/sec with pots, White
7-07050-BLK	QPT-20XD	12 VDC; pan 435°, 23°/sec; tilt ±90°, 12°/sec with pots, Black
7-07055	QPT-20XD	12 VDC; pan 435°, 23°/sec; tilt ±90°, 12°/sec, White
7-07055-BLK	QPT-20XD	12 VDC; pan 435°, 23°/sec; tilt ±90°, 12°/sec, Black

### KEY FEATURES:

- Weatherproof, suitable for Inverted Operation
- 435° pan rotation
- 20 pound load (12 & 24 VDC), 15 pound load (24 VAC)
- All metal gearing for improved durability
- Aluminum housing with powder coat finish for white & black models
- Improved torsional rigidity of both housing and table
- Improved corrosion resistance
- Single bolt cover access for internal limit switch adjustments
- Optional heater is available
- Position feedback encoders or potentiometers available in certain models

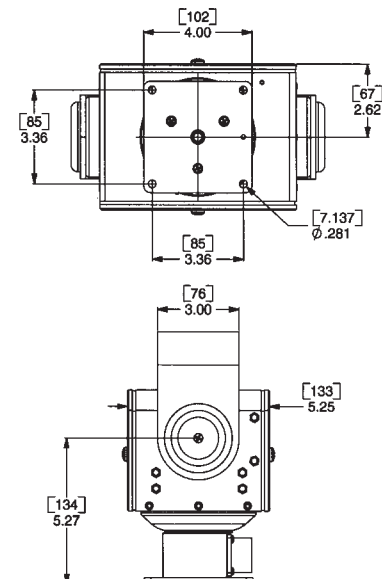
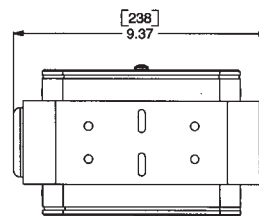
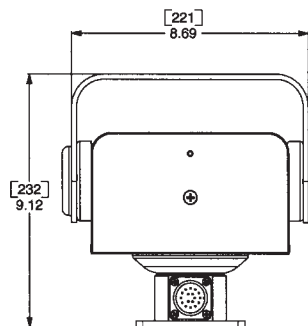

Dimensions are in inches [mm]

**For Those Who Demand Durability!**

# SPECIFICATIONS OF PAN & TILT QPT-15XD/QPT-20XD

	<b>QPT-20XD (Variable Speed)</b>		<b>QPT-15XD(Fixed)</b>
<b>Voltage</b>	<b>12VDC</b>	<b>24VDC</b>	<b>24VAC 60 hz</b>
<b>Load Capacity</b>	20 lbs. (9.07kg)	20 lbs. (9.07kg)	15 lbs. (6.8 kg)
<b>Pan Range</b>	435° ±217.5°	435° ±217.5°	435° ±217.5°
<b>Pan Speed Range (± 1°)</b>	1° - 8° / sec.	1° - 35° / sec	8° / sec. fixed
<b>Pan Torque</b>	35 inch-pounds	35 inch-pounds	35 inch-pounds
<b>Pan Motor Current</b>	0.3 amp	0.15 amp	0.3 amp
<b>Tilt Range</b>	180° ±90°	180° ±90°	180° ±90°
<b>Tilt Speed Range (± 1°)</b>	1° - 3° / sec.	1° - 12° / sec.	3° / sec. fixed
<b>Tilt Torque</b>	90 inch-pounds	90 inch-pounds	70 inch-pounds
<b>Tilt Motor Current</b>	0.7 amp	0.5 amp	0.27 amp
<b>Motor Type</b>	Permanent Magnet	Permanent Magnet	PM, Split Capacitor
<b>Connector</b>	17 pin (mating connector included)	17 pin	14 pin
<b>Dimensions</b>	9.12"H x 9.37"W x 5.24"D (232mmH x 238mmW x 133mmD)		
<b>Weight</b>	13.1 lbs. (5.94 kg)		
<b>Drivetrain</b>	Steel gear, steel worm(coated), & self-aligning bearings		
<b>Limit Switches</b>	Internal		
<b>Backlash</b>	Adjustable to 0		
<b>Repeatability</b>	0.25°		
<b>Material</b>	Housing - Aluminum 6061 - T6, External Hardware - Stainless Steel		
<b>Exterior Color/Finish</b>	White (Dupont 326162A, Ford PFWS9) & Black (flat black) are Powder Coated (Olive Drab units not powder coated) (custom colors/private labeling upon request)		
<b>Environmental Enclosure</b>	Gasketed & sealed, suitable for <b>Inverted Operation</b>		
<b>Operating Temperature</b>	+5°F to +131°F (-15°C to +55°C) (without Heater) -28°F to +131°F (-33°C to +55°C) (with optional Heater)		
<b>Heater</b>	Optional <b>heater</b> is available		
<b>Position Feedback</b>	<b>Encoders</b> or <b>potentiometers</b> available in certain models		

\*Specifications may change without notice

## TABLE TOP MOUNTING HOLE DIMENSIONS

Dimensions are in inches [mm]

