



The Sentry line of pan and tilts have been developed specifically for modern long-range video surveillance applications. These products offer substantial multi-sensor payload capacity with the widest dynamic range available with more than 5,000:1 ratio between high and low pan speeds. This means that the units can slew to a target location extremely fast, and then shift to very slow pan mode for tracking at the longest ranges possible. Utilizing QuickSet's proprietary QuickShift® technology, the rate can switch instantly upon operator command. The Sentry family uses optical encoders to achieve repeatability of 0.05 degrees in both pan and tilt.

With onboard electronics, these units can communicate with two mounted imagers while storing dozens of preset locations and tours, offering the most automated pan and tilt products on the market. Designed from inception as a powerful product, the Sentry Atlas is able to lift and position loads from 200 to 500 foot pounds.



Extremely Powerful	The Sentry Atlas weighs just over 125 lbs.
Powerful torque vs. size ratio	Payloads requiring 500 foot pounds of torque can be handled with ease.
0.01° angular position resolution and readout with 0.05° repeatability	Very long range optical systems can be programmed to return to exactly the same location every time.
Extremely wide dynamic range	With a variable speed range of 5,000:1 between high and low pan speeds, systems can be designed to rapidly acquire any target, then the unit can be controlled very finely for optimum viewing of distant targets.
Dual camera controller built in (not wired outside)	This greatly reduces the system design by embedding all the camera controls for two imagers (typically visible and thermal) within the pan and tilt unit. (Requires wiring)
QuickSet technology	Exclusive to QuickSet is the ability to digitally change ranges of speed to allow the imagers to acquire targets quickly, then shift to pan and tilt speeds much slower for smaller incremental viewing.

## Key Features continued

Voltage:	48VDC
Load Capacity:	500 ft.-lbs.
Duty Cycle:	Intermittent
Pan Range:	360° (±180°)
Pan Speed Range:	0.002° to 10.5°/s (at 160 ft.-lbs.) with QuickShift technology
Tilt Range:	180° (±90°)
Tilt Speed Range:	0.001 to 3.5°/s (at 500 ft.-lbs.) with QuickShift technology
Pan and Tilt Repeatability	Pan- 0.05°, Tilt- 0.05°
Resolution & Readout:	0.01° resolution and readout
Current Draw:	10 amps max without heaters, 13.5 amp with heaters
Weight:	125 lbs (approximately)
Exterior Color/Finish:	Marine white powder coated, external hardware all stainless steel (other colors available)
Environmental Enclosure:	Gasketed and sealed to withstand water and dust penetration
Operating Temperature:	-22°F (-30C) to +131°F (+55°C) includes heater
2 Auxiliary relay controls:	Can be used to power relays to turn on wipers, auxiliary light bar, or near/far on IR camera's, etc Executed through software commands. (Requires wiring)
Embedded commands:	Electronic limits pan and tilt. 32 preset locations, including home position.
Software:	(Requires Windows 95 SR2, 98, ME, XP, or 2000; not compatible with Windows NT) Virtual joystick Tour (3) each tour may have up to 64 positions (of 32 presets) Diagnostic
Test cable:	6 foot test cable supplied
Connector:	MIL SPEC 24-pin (mating connector supplied)
Protocol documentation:	Supplied
Communication to Pan/Tilt	RS232 / 422/485 / IP (switchable)
Communication to auxiliary devices:	RS232 / 422
Integrated video switching:	Internal (Requires wiring)
Internal Lens Motor drivers:	Operate most common camera lenses. (zoom and focus dual camera operation) (Requires wiring)

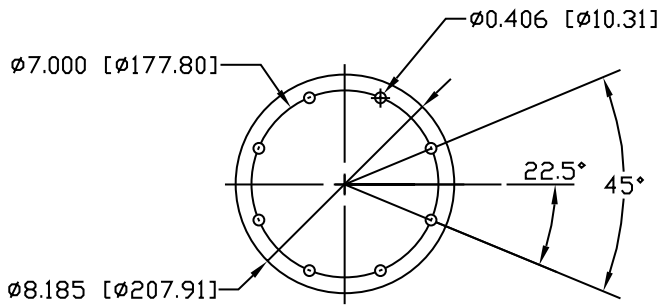
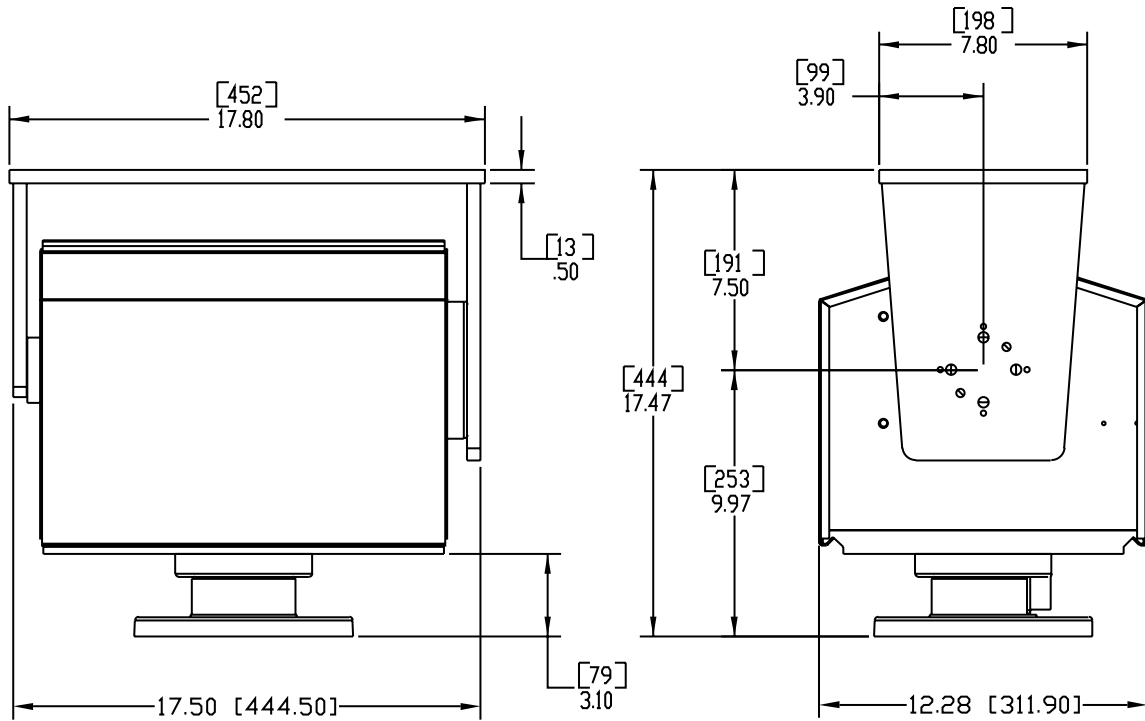

BASE DIMENSIONS

Dimensions in inches [mm]

